

Chain Link Assembly



Description

The chain link assembly is used for flexible alignment and connection of other accessories, in particular manual handling test applications. The 500 N capacity version is often used for ease of sample loading with lightweight vice grips, vice clamps and wedge grips.

Applications

Used for general purpose tensile testing of:

- manual handling

Specifications

Part No.	Load Capacity	Thread 1	Length	Weight
432-259	500 N / 50 kgf / 110 lbf	10-32 UNF	68 mm (2.68")	32 g (0.07 lb)
PSV8057	2.5 kN / 250 kgf / 550 lbf	5/16 UNC	130 mm (2.68")	158 g (0.35 lb)

Dimensions mm (inch)

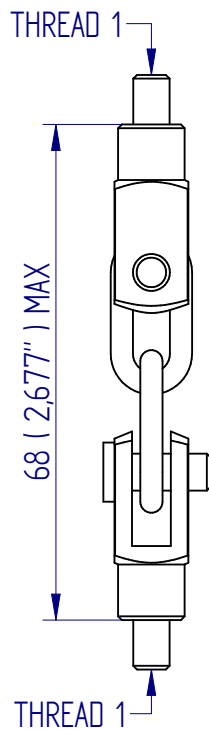

432-259

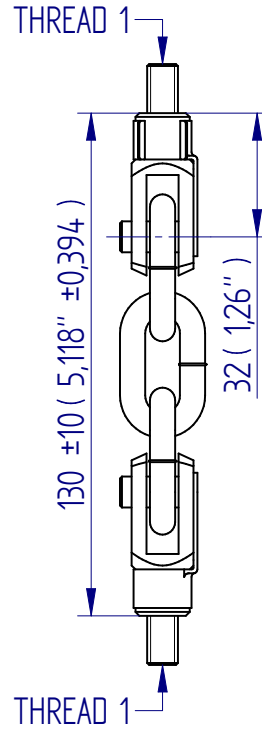

PSV8057



FS 58553

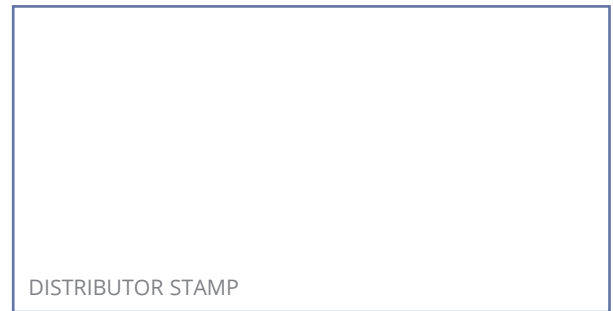

Mecmesin reserves the right to alter equipment specifications without prior notice.
E&OE

Head Office
Mecmesin Limited

w: www.mecmesin.com
e: sales@mecmesin.com

North America
Mecmesin Corporation

w: www.mecmesin.com
e: info@mecmesincorp.com

France
Mecmesin France

w: www.mecmesin.com/fr
e: contact@mecmesin.fr

Asia
Mecmesin Asia Co., Ltd

w: www.mecmesin.com/th
e: sales@mecmesinasia.com

Germany
Mecmesin GmbH

w: www.mecmesin.com/de
e: info@mecmesin.de

China
Mecmesin (Shanghai) Pte Ltd

w: www.mecmesin.com/zh
e: sales@mecmesin.cn