

Lever-operated Cam Grips

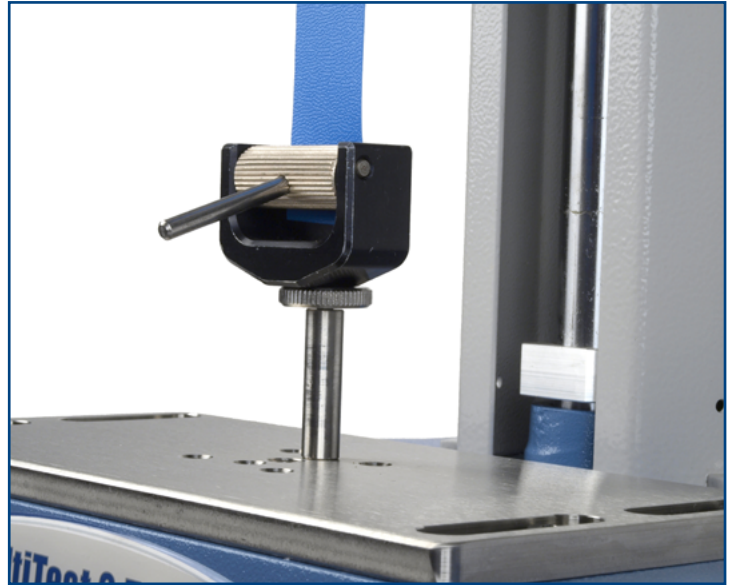

Description

Lever-operated cam grips are designed to self-tighten as load is applied, and spread the load evenly. The lever also allows for quick insertion and release of samples.

Applications

- dumbbells
- elastomers

Specifications

| Part No. | Load Capacity | Thread 1 | Maximum Sample Size (Width x Thickness) | | Height | Weight |
|----------|--------------------------|-----------|---|---------------|---------------|-----------------|
| 432-383 | 500 N / 50 kgf / 110 lbf | 10-32 UNF | 30 mm x 5 mm | 1.18" x 0.20" | 29 mm (1.14") | 100 g (0.22 lb) |
| 432-047 | 500 N / 50 kgf / 110 lbf | 10-32 UNF | 70 mm x 5 mm | 2.76" x 0.20" | 29 mm (1.14") | 100 g (0.22 lb) |

Dimensions mm (inch)

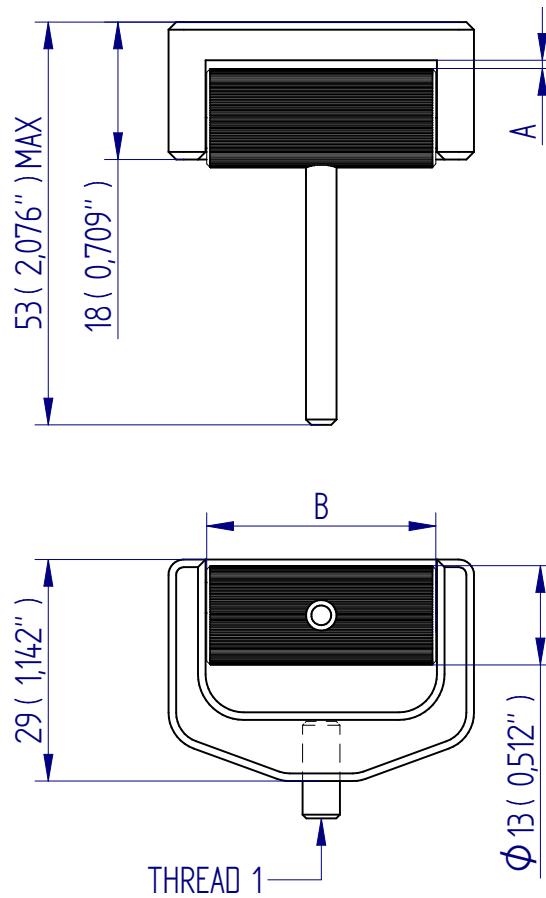

FS 58553

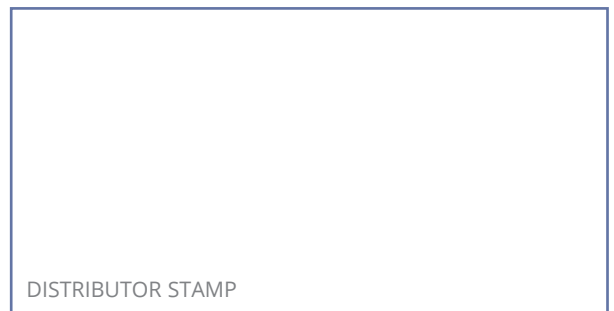

Mecmesin reserves the right to alter equipment specifications without prior notice.
E&OE

Head Office
Mecmesin Limited

w: www.mecmesin.com
e: sales@mecmesin.com

France
Mecmesin France

w: www.mecmesin.com/fr
e: contact@mecmesin.fr

Germany
Mecmesin GmbH

w: www.mecmesin.com/de
e: info@mecmesin.de

North America
Mecmesin Corporation

w: www.mecmesin.com
e: info@mecmesincorp.com

Asia
Mecmesin Asia Co., Ltd

w: www.mecmesin.com/th
e: sales@mecmesinasia.com

China
Mecmesin (Shanghai) Pte Ltd

w: www.mecmesin.com/zh
e: sales@mecmesin.cn